



For the **life** of your dairy™

# ***XCALIBUR 360EX 2.0***

## **NEXT GENERATION ROTARY**



***Taking Our Xcalibur 360EX  
to the Next Level!***



# BouMatic<sup>®</sup>

For the **life** of your dairy™

**BEING KINDER** to the cow and maintaining the highest quality of milk harvested is, and always will be, our focus. We have brought many years of experience with milking technology and best practices in milking, together into a cow focused milking machine, which is compact, durable, reliable and easy to operate and service.

**EACH COW BENEFITS** from the industry's leading milking expertise integrated with a forward-thinking machine design. One of the greatest advantages is computerized monitoring provides the dairy manager with extensive individual animal information. Data analysis and herd control, combined with BouMatic's milking expertise and support, enhances the dairy farmer's milking insights and herd management and lead to an optimal dairy operation.

# Why are you a dairy producer?

## BouMatic is for the life of your dairy



The work is hard. The hours are long. The reward isn't always measured in that milk check. But you give it your all, every day. You're a dairy producer because caring for cows is more than a business.

### *This is your life.*

BouMatic understands what that really means. We've spent the last century improving the way cows are milked and dairy producers evolve their operations to meet the future. Today, BouMatic is ready to help you create the dairy you need to succeed and live the life you envision, with innovative products, forward-thinking solutions and boots-on-the-ground service. BouMatic offers a full-range of milking products, from bulk cooling tanks and route service essentials to automated milking systems and computerized management tools - each developed to improve the life of your dairy.





Next generation

# Revolutionized rotary

This is the ultimate in rotary milking systems. Built for continuous, around-the-clock milking, the Xcalibur 360EX 2.0 upgrades the ruggedly built Xcalibur 360 with precision engineered to deliver unrivalled throughput and maximum efficiency for your dairy operation.

This rotary is available in a basement version from 40 to 150 stalls and is ideal for commercial farms with herds from 1,500 to 12,000 cows.

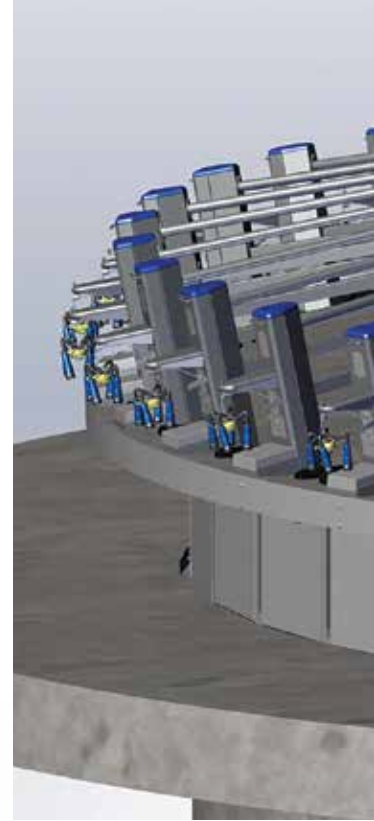

## Horizontal detach cylinder

The cylinder is placed in a closed tube with a front access panel. This design allows for easy servicing of the cylinder.

Our cylinder is a modern rodless magnetically coupled pneumatic actuator. Without pulleys and pins the cylinder has fewer wear components. It also is not susceptible to the same environmental variables that can damage a standard vacuum or air actuated cylinder.



## Compact cabinet

With a modern appearance, the cabinet is slim and compact. The additional space is user and technician friendly and provides a better view of milking.

The automation panel is correctly positioned for operator comfort.



## Low profile bail

At one meter in height this aids in a comfortable spacing for the cow.



## Maximized unit alignment

The rope and chain guides are positioned to promote unit alignment and hose support usage. The guide keeps the cluster and hose away from the jetter tray.



— up to —  
**150 STALLS!**



### Rugged, dependable drive systems

The Xcalibur™ 360EX electric drive system delivers smooth, dependable performance. It operates 2-8 drive units (depending on platform size) on 240 and 480 volt, 3 phase with 50/60 hertz. Includes safeties for both operator and animals and uses an external braking resistor to quickly stop the platform.



### Best-in-Class Rotary

BouMatic rotaries have always been highly regarded for their quality, comfort, and reliability. We have the best undercarriage and drive system in the industry. Our double I-beam design with support plate and nylon rollers lasts 15 years with very low maintenance. Even with sand bedding you will find reduced wear with our design.



### Outside skirting

The rotary skirt is placed inward giving ample space under the outer curb and plenty of room for future automation additions.

Again, with ease of service in mind, now accessing jettors, hoses, air lines and automation becomes nearly hassle-free.

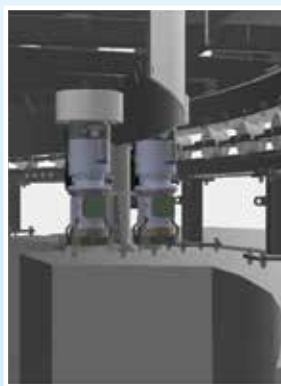

### Serviceability

The drives are located to the inside of the I-Beam and closer to the center of the rotary resulting in easier installation and servicing for the drives. The design provides unrestricted access to the underside of the platform.

Rugged and powerful

# Below the Deck

*Milking more cows every hour is on the agenda for many dairies. BouMatic's legendary milking system performance is married with a full range of platform sizes. Together they set the pace for the rest of the industry without sacrificing the fundamental principle of harvesting the highest quality milk, quickly, gently and completely.*



## Electrical Drive System



The Xcalibur™ 360EX drive system will deliver a smooth dependable performance. Redundant variable frequency drive system is standard and minimizes chance of downtime.

Runs smoothly and quietly with no interference with ID systems with internal EMC filtering and transient protection. Safeties for the operator and animals and use an external braking resistor and airbags to quickly stop the platform.

Drive Islands are located inside of the I-beam and closer to the center of the rotary for easy install and service. By simply removing covers, the drives are accessible from all angles.



## Platform and Roller System

The Xcalibur™ 360EX concrete platform structure includes bottom plate, rebars material, inner and outer curbs, spokes and central point.

Our exclusive double I-beam design with wear plate and nylon rollers has been proven to last over 15 years. It is an extremely low maintenance design and withstands heavy usage even in conjunction with sand bedding.

The installation is sleek in that only the rump rail posts and center turn table need to be in place before the floors are poured for the milking parlor. There are no posts or cabinets to pour concrete around on the rotary deck.

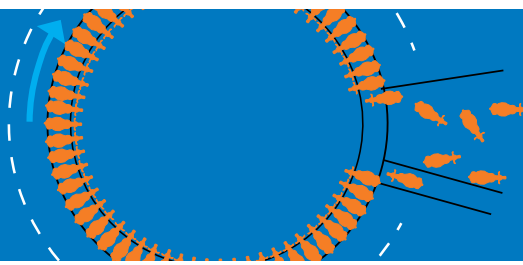

# Xcalibur 360EX 2.0



## Wash Line

The wash line safety has switches that prevent the rotary from turning until the wash lines are properly unhooked from the rotary.

The receiver and wash lines are towards the center of the rotary and have easy access for servicing. Access to hoses, air lines, meters and are free of obstructions.



## Swivel

In order to correspond to the new platform offering of 40-stalls to 150-stalls, the swivel needs to be able to change its size to fit the necessary functions. Therefore, there are many swivel and center gland sizes available based on the rotary size.

The center gland has the ability to transfer three key services; milk, vacuum and water. It also acts as the electrical hub.

As dairy operations rely on more and more automation that add to their extensive electrical needs, the swivel needs to be sized to accommodate. BouMatic has very robust and secure ways for handling any operations needs.



## Safeties

Safety is a top priority for any operation. BouMatic does extensive testing and research to make sure that we offer a system that is safe.

There is an entrance gate safety switch that stops the rotary for cows if they don't get on all of the way. It automatically restarts when the cow clears the safety gate.

There are emergency stop cables and switches located around the platform and entry/ exit gates to avoid injury to workers and cows. In addition an emergency stop button on the control console shuts down the electric drive system.

Additional pull ropes for safety are located in the basement.

Comfort and milkability

# Above the Deck

*The life of your dairy begins with milking cows gently, quickly and completely. BouMatic milking systems provide a more natural, comfortable, and therefore more productive milking experience. The Xcalibur 360EX 2.0 is built around maximizing comfort and milkability for cow and productivity for the operator.*



## Stall Work

The Xcalibur™ 360EX stall work is a robust 2.5 in tubing that bolts on after concrete is poured.

The stall profile is low at 1 meter high, and is open and inviting to the cow with the neck and brisket rails able to adjust.

The 29" stall width is able to accommodate larger breeds but tight enough for smaller breeds.

Select from stainless steel or blue plastic slobber shields.



## Cabinets

The Xcalibur™ 360EX cabinets are available in a hot-dipped galvanized or in a stainless steel construction; both options have a blue plastic top accent cover.

The automation electronics are integrated into the cabinet and well in reach of the operator and kept water-tight by the cabinet.

A very robust stainless steel jetter tray is integrated into the cabinet. The cover is sloped for each washing.



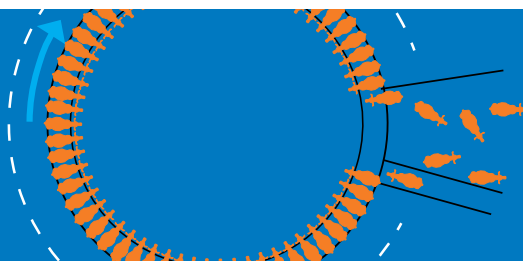

# Xcalibur 360EX 2.0



## Horizontal cylinder placement

Our cylinder is a modern rodless magnetically coupled pneumatic actuator. Without pulleys and pins the cylinder has fewer wear components. It also is not susceptible to the same environmental variables that can damage a standard vacuum or air actuated cylinder.

Our horizontal detacher cylinder is placed along the stall dividers. The cylinder is able to slide out from the front of the cabinet for changing of rope and other key service items.

Shrouds surrounding the cylinder can be removed to further improve accessibility when needed.



## Unit and hose alignment

The cabinet's front guide properly positions the rope or chain attached to the milking unit.

The fold-down hose support arm works well with the guide to achieve proper alignment. It hose support lays down flat on the deck when not in use so that they is no interference in cow flow or operator's movements.



Concrete Deck



Rubber flooring



Tile decking

## Deck options

BouMatic offers 3 different options for the deck surface. The concrete only option is reliable and a low cost option. Rubber flooring can be added to maximize cow comfort. Tile decking is the most durable and heavy duty option. The tile is a very thick style that is commonly used in cheese plants.





Select for your herd and operation needs

# Sizes and Finishes

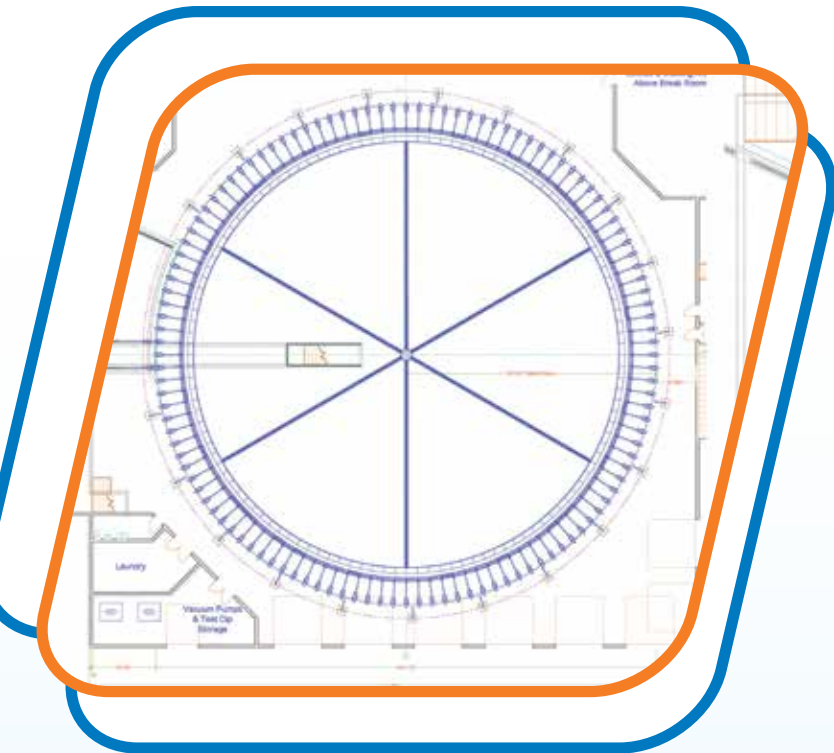

## Sizes

The rotary is available in basement version from 40 to 150 stalls. It can milk beyond 1,000 cow per hour.

The chart below is to help indicate the cow throughput that can be achieved for each rotary size based on speed of rotation.

## Finishes

Selection of the finish of the rotary is available from 40 through 80 stalls. Rotaries over 90-stalls in size will be standardized to the all stainless steel finish.

**Cows per Hour at Given Rotation**

Rotary Size	Turns per Hour			
	6.5	7	7.5	8
40	260	280	300	320
50	325	350	375	400
60	390	420	450	480
72	468	504	540	576
80	520	560	600	640
90	585	630	675	720
100	650	700	750	800
110	715	770	825	880
120	780	840	900	960
130	845	910	975	1040
140	910	980	1050	1120
150	975	1050	1125	1200



Rotary Size	Finishes			Drive System*	Standard Entrance	Standard Exit	Bridge Extension
	Galvanized	Galvanized/ Stainless	Stainless Steel	# of 2x Drives *	Cow Width	Cow Width	(adds 1 cow width to bridge)
40	Y	Y	Y	1	1.5	3 stall	Option Available
50	Y	Y	Y	2	1.5	3 stall	Option Available
60	Y	Y	Y	2	1.5	4 stall	Option Available
72	Y	Y	Y	3	1.5	4 stall	Option Available
80	Y	Y	Y	3	1.5	4 stall	Option Available
90	N	N	Y	5	2.0	4 stall	Option Available
100	N	N	Y	5	2.0	5 stall	Option Available
110	N	N	Y	6	2.0	7 stall	Option Available
120	N	N	Y	8	2.0	7 stall	Option Available
130	N	N	Y	8	2.0	8 stall	Option Available
140	N	N	Y	8	2.0	8 stall	Option Available
150	N	N	Y	8	2.0	8 stall	Option Available

## Precision Control of the Rotary

Our rotary control is designed to create an environment with safety and information in mind for the operator, the cow and the equipment. The BouMatic rotary controller uses a modern PLC to house the logic and controls for the rotary platform.

The panel of the controller box is equipped with easy-to-see & read alarm LED's to assist the user in quickly identifying the source of an alarm event.

The Graphic User Interface (GUI) settings and selections of rotary controller are accessed remotely using a laptop or computer, if any parameters require adjustment.

Easy to use manual override for emergency situations. Prevents down time!



**Rotary Ready:**  
*Lit when in 'Stand-by' mode, ready to move*

### **Temporary Stops for Rotary**

**Stop Circuit:** Lights-up when an error occurs

**Entrance Gate FWD:** If cow has not fully entered in allotted time or distance

**Exit Gate FWD:** If cow has not exited in allotted time or distance

**Ultrasonic Sensor:** Proximity sensor that detects an object

**Stop Cable (L/R):** Pull rope activated on exit or entrance side of parlor

**Stop Prox Bridge:** Proximity sensor detects object near bridge

### **Emergency Hard Stops for Rotary (requiring reset)**

**E-Stop Circuit Light:** Lights up when an E-stop event occurs

**Operator Panel:** Main E-Stop at panel tripped

**Basement Cable:** Pull rope tripped in center of rotary

**Mat:** Safety Mat stepped on or activated near bridge

**Wash Hose (L/R):** Proximity sensor for wash hose connections

**Electric Drive Panel:** Sensor detects main panel is open

# Simple yet State-of-the-Art Automation

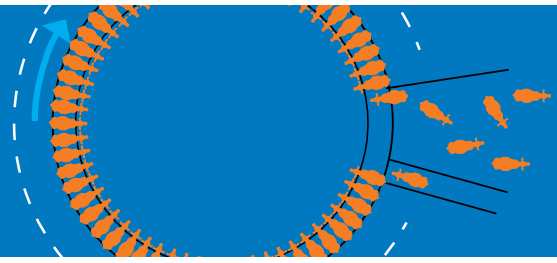

## ViewPoint™

For dairy operators who want their milking crew to concentrate on quality milking procedures ViewPoint is ideal – a simplified milker interface with a single remote start button and single LED.

When limited time is available to access data at each stall point, ViewPoint offers a milker interface for the entire milking facility, through one or more optional ViewPoint touchscreens placed in the parlor.

The ViewPoint TouchScreen can be programmed to provide information needed for the entire parlor, plus vital individual cow data can also be accessed at the touch screen.

The SmartControl™ Meter measures and collects individual cow milk production information and delivers it to your herd management software via the SmartDairy Controller. Real time direct data output and control is provided through ViewPoint controls.

All data collected by the SmartControl Meter is sent to the SmartDairy® controller. The SmartDairy software milk harvest module delivers the critical reports, tables and information you need. The SmartDairy controller will also interface with your parlor management software.



## SmartLite™

With the bright, multi-colored LED button you have an instant overview of the milking status at each stall and can react to any challenges that may arise.

The optional SmartLite PC Management Software provides data that is essential to your individual management needs, such as milking event logging, milking progress information, milking duration, and alarms.

You can share historical data with third parties, such as veterinarians or consultants, and even follow the milking phase of each cow on the computer. This will help you better understand your milking routines and improve your overall milking performance.

The SmartLite can be used as a standalone or with the Smart-Connect™ controller.

We outfit your whole farm!

# Milk Harvest Champions



## Pulse MD™

Let Pulse MD monitor your parlor performance and rest easier knowing you will be alerted to key issues. Pulse MD provides assurance that your system is working correctly – every milking on every cow!



## Hi-Flo™ Evolution

The HiFlo Evolution is the ultimate in durability and simplicity. Made up of only eight different parts, it is easy to install and easy to clean. The HiFlo Evolution is designed to save you time and money while delivering perfect and reliable pulsation.



## OptiFlo™ CF

The only true variable speed milk pump control giving you the ultimate in cooling system efficiency. Optimizing the milk flow rate through the plate cooler for the best cooling system performance.

## The Ultimate Combination: Flo-Star Claws & Magnum Liners



The Flo-Star Xtreme has BouMatic's patented x-crossed inlet design for the best "cow-fit". It is extremely low profile and lightweight. The air inlet design always keeps a stable vacuum to the claw. Get the enhanced performance you never thought you could achieve.

Magnum liners have a unique design that promotes milk let-down and gentle milking. They are made of high-quality rubber compound which ensures durability and longevity. The liners are also easy to clean and sanitize, ensuring the safety and health of your cows. Select either Magnum or Magnum TL "Turbo" design liners.





# CowSeeker

## BouMatic CowSeeker Heat Detection with Health Monitoring

*The BouMatic CowSeeker, a health and rumination monitoring system, cover small farms or large pasture-based farm distances thanks to the (optional) auxiliary radio, which transmits data wirelessly to the main antenna radio, making all the advantages of health monitoring available to all dairys.*

- 1** The BouMatic CowSeeker tag registers the activity and behavior of the individual animal. Data for the last 24 hours is stored in the tag.
- 2** All data is retrieved once the animals come within range of the antenna. If the animal is already in range of an antenna data is transmitted every 15 min.
- 3** The ID Controller analyses the data continuously.
- 4** The results of the analysis can be read on your smartphone, tablet or PC. The system immediately sends an alert on heat detection and for anomalies in the eating pattern, and deviations in the rumination amount of activity level.

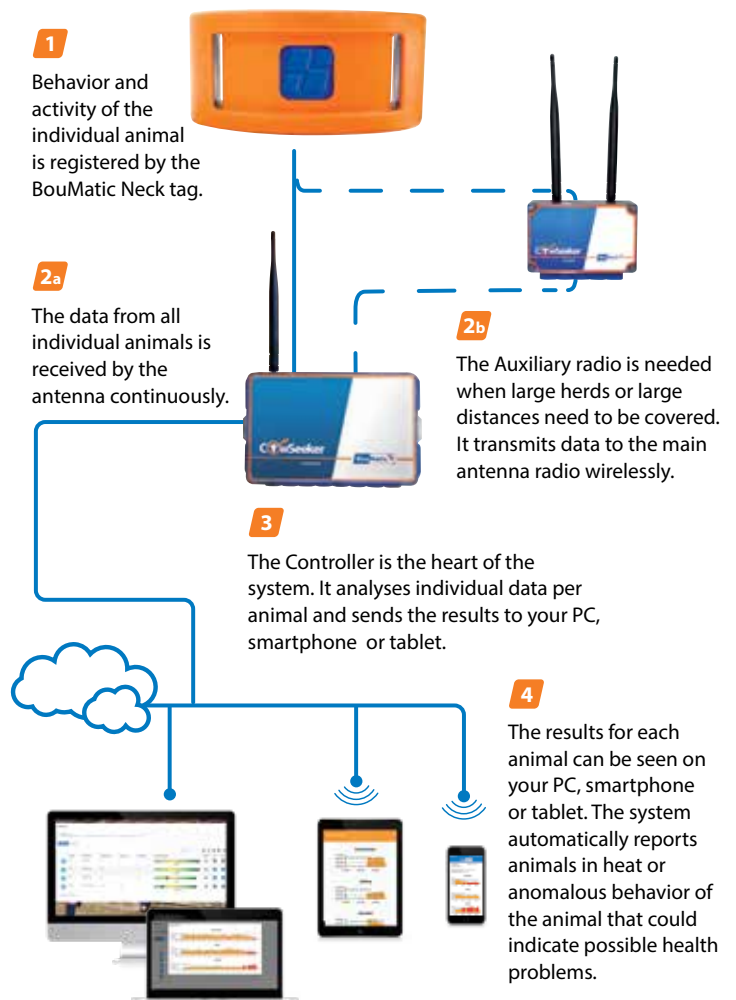

# Optimal Cooling Efficiency

Protect your milk harvest with proper refrigeration.

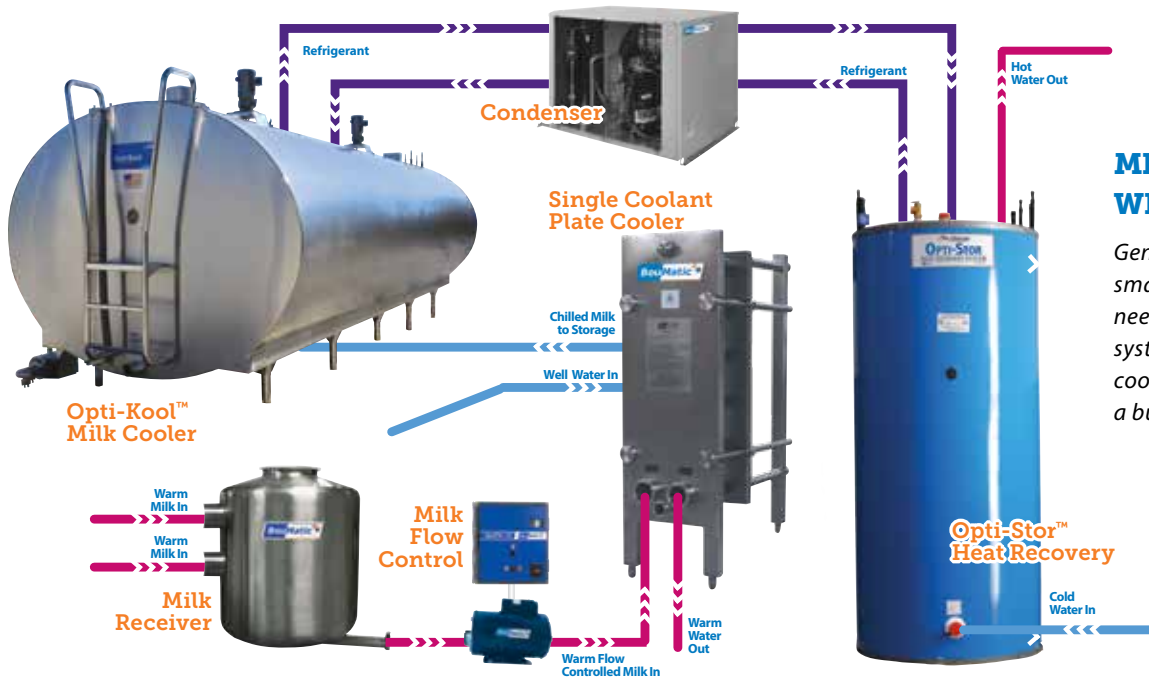

## MILK COOLING WITH TANK

Generally dairies smaller than 700 cows need not consider any system other than milk cooling and storage in a bulk milk tank.



## INSTANT COOLING WITH CHILLER

Dairies larger than 700 cows are good candidates for the direct-load system. Depending on milk production and milking facilities, these dairies may benefit more with the direct-load option.

*“Before we installed the rotary, it took an hour to milk cows,” he said. “Now it takes 20 minutes. Less time is involved with milking three times a day.” The Roden family installed a BouMatic rotary in 2022 and could increase the herd to 1,200 or more cows because milk production and efficiency have improved. Within about 12 months of the system’s installation the family saw an increase of 10 pounds of milk per cow per day, he said. The increase is due in part to increasing the milking schedule from two to three times daily. The new system also provides cows more time to rest and ruminate.*

*Rugged rotary built for whatever your dairy requires, we have what you need.*

Source: [https://agupdate.com/agriview/news/business/celebrate-dairy-high-tech-fun/article\\_01c70b74-fd30-5c90-9c7a-1823c21433b2.html](https://agupdate.com/agriview/news/business/celebrate-dairy-high-tech-fun/article_01c70b74-fd30-5c90-9c7a-1823c21433b2.html)





## Health Review

### Farm Evaluation

Our BouMatic staff has decades of experience. Let our highly skilled team work with you to provide you with insight into your farm operation and design.

### Facility Planning & Design

Our Dairy Solutions team can assist in your facility planning and barn layout. We can assist in conceptual designs, draftings, and technical drawings.

After installation we can offer 360-degree virtual tour, drone photography and videos.

### Farm Management Solutions

Our highly skilled team can coach producers through usage of our SmartDairy or SmartConnect systems.

You will want to make the most out of your automation data to assist you in making the right decisions for your operation.

### Milk Quality and Milking Performance

BouMatic wants dairy farmers to reach their milk quality goals and achieve top-notch milking performance. We specialize in troubleshooting complex milk quality issues.

We can perform Vacuum Analysis, CIP Dynamic Wash Analysis, Pulsation Analysis, and more.

### Cow Comfort

BouMatic has a staff veterinarian that can assist in reviewing cow traffic, teat conditions, bacterial issues and general cow comfort needs.

# Extended Service Plans Available!

*Ask your Sale Manager for details.*



***Lock in the price for service kits annually with your BouMatic dealer.***

***Protect yourself from potential price increases.***

***Lower your day-to-day cost of managing multiple suppliers.***





## We guide you from A to Z

Whenever you start up a BouMatic milking system on your farm, the BouMatic specialists will always guide you to set it up right. We provide assistance with many aspects to smoothly integrate the rotary into your operation. From conception and launch to your day-to-day operation, you can count on us to support you at every step and help you to milk your cows with peace of mind.

### Maximize your work life balance

Our well-trained dealer network is your first point of contact to check in on your system and to help where needed.

### Program include the following Service Kits:

Part No.	Service Kit
8584808	Service Kit, HiFlo Evolution Pulsator
3556621	Service Kit, Smart Control Milk Meter
8596267	Service Kit, Air Actuated Shutoff Assembly, 10 pack
3559260	Service Kit, Vacuum Actuated Shutoff Assembly, 10 pack
8600916	Service Kit, Claw Gaskets, Flo-Star MAX and Xtreme, 10 pack

Supervised installation leading to  
**Quality Assurance**

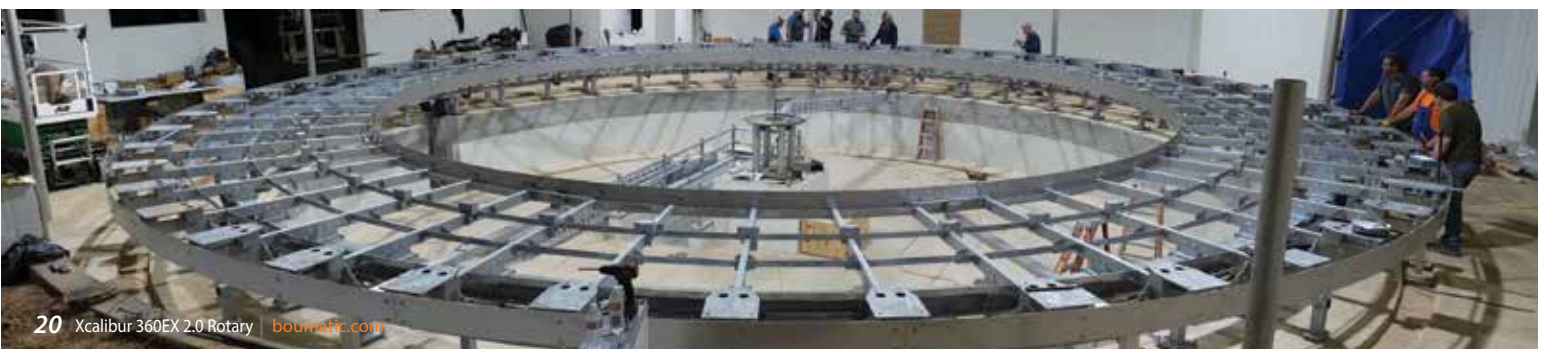

*All over the world BouMatic is creating happy environments for happy cows. We know when she is feeling her best she is going to do her best. With BouMatic, you can always be sure we milk quickly, gently, and completely, making the life on your dairy almost effortless!*





# Better milk for Farmers, Better life for Cows!





## DRIVEN BY OUR MILKING PHILOSOPHY

BouMatic is a global leader recognized for its innovative dairy farm products. BouMatic is dedicated to ensuring that dairy farm producers throughout the world have the ability to produce the highest quality milk most efficiently, profitably and responsibly.

## COW FOCUSED STAFF AND DEALERS

All BouMatic staff and dealers receive in-depth training in milking technology and will always base their thoughts, decisions and actions on the BouMatic milking philosophy. In practice, this translates into numerous tangible benefits for the end-user. As a professional farmer, you can expect the best tailored advice from the BouMatic milking experts, combined with milking solutions that are optimally designed to enhance your efficiency and the comfort of your cows. Together, we will strive to get the best milking results for your dairy farm.





**Wisconsin, USA**

PO Box 8050  
Madison, WI 53708  
T +1 608 222 3484  
F +1 608 222 9314

**Canada**

Mailing  
PO BOX 2050  
Vaughan Harvey PO  
Moncton, NB E1C 0T3

Shipping  
28 Elizabeth St.  
Moncton, NB E1C 9T1

T +1 226 884 1375  
F +1 226 884 1376

**The Netherlands**

Transportweg 6  
8304 AX Emmeloord

T +31 (0)527 820 110  
F +31 (0)527 788 599

**Belgium**

Rue Jules Mélotte 31  
4350 Remicourt

T +32 (0)19 54 42 66  
F +32 (0)19 54 55 44

**Denmark**

Jernvej 2  
6900 Skjern

T +45 7694 5525  
F +45 7526 0396

**Dealer:**

info@boumatic.com  
www.boumatic.com